

## Tutorial Set 2: Data interpolation

### Exercise Site20\_2-5 Summarizing points data within polygon

**Learning objective:** Obtaining descriptive statistics of yield under different agriculture treatment plots

**Techniques:** Spatial Join

**Data Source:** Dataset2

1. Bring the two layers *Field20\_Treatments.shp* and *Field20\_Soybean\_2010.shp* to ArcMap.

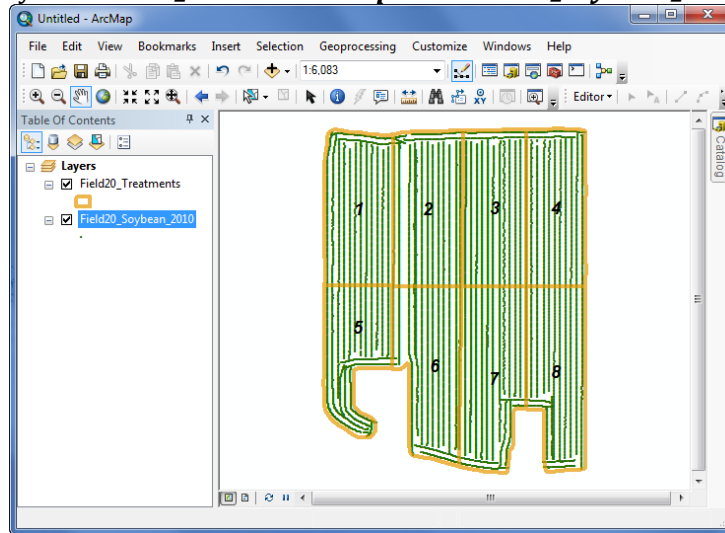

2. In **Table of Content**, right click on *Field20\_Treatment* and go to **Joins and Relates** -> **Join**

...

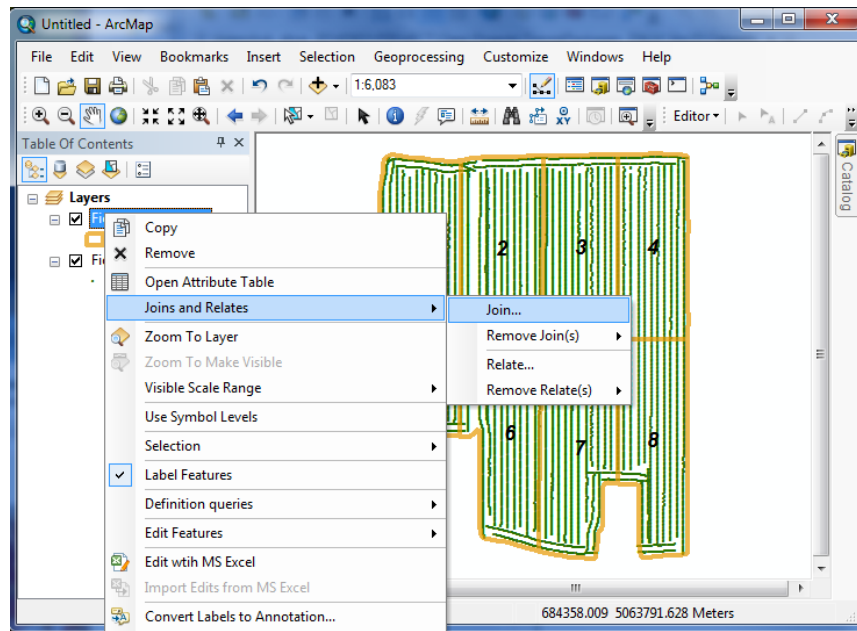

3. In **Join Data** dialog window, set parameters as:

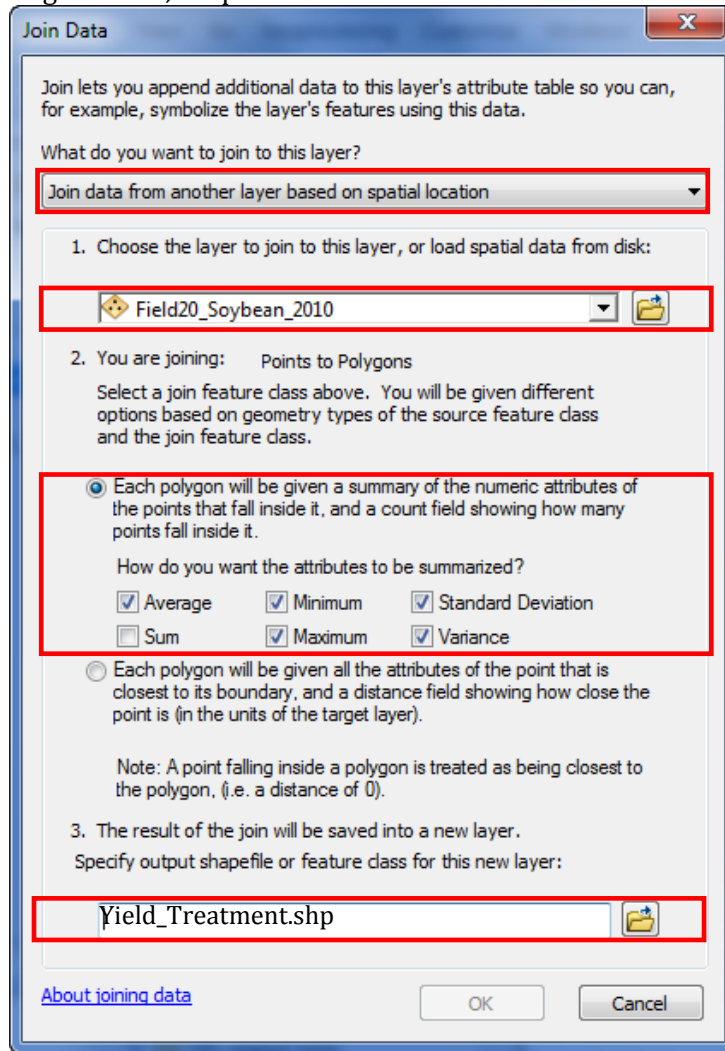

4. Click **OK**.

5. A new layer **Yield\_Treatment** is added to **Table of Content**. Right click on this layer, and go to layer **Properties** -> **Symbology** to show the values of the field **Avg\_YIELD**.

